

TOWN OF MT. CRESTED BUTTE  
ORDINANCE NO. 1  
SERIES 2001

**AN ORDINANCE OF THE TOWN COUNCIL OF THE TOWN  
OF MT. CRESTED BUTTE, COLORADO, ANNEXING THE  
PROPERTY COMMONLY KNOWN AS THE "EAST TRADE  
PARCEL" INTO THE TOWN OF MT. CRESTED BUTTE,  
COLORADO**

WHEREAS, a petition for annexation of the property commonly known as the "East Trade Parcel", more particularly described in the attached Exhibit A, was filed with the Town of Mt. Crested Butte, Colorado, on September 11, 2000, by CBMR Real Estate, LLC, a Colorado limited liability company, as owner; and

WHEREAS, the Town Council of the Town of Mt. Crested Butte, Colorado, has previously found said petition for annexation to be in substantial compliance with Colorado state law; and

WHEREAS, the Town Council of the Town of Mt. Crested Butte, Colorado, has previously determined that the property described in the attached Exhibit A is eligible for annexation to the Town of Mt. Crested Butte, Colorado, without an election pursuant Colorado state law; and

WHEREAS, the Town of Mt. Crested Butte, Colorado, and CBMR Real Estate, LLC, have agreed upon the terms and conditions for the annexation of the property described in Exhibit A;

**NOW, THEREFORE, BE IT ORDAINED BY THE TOWN COUNCIL OF THE  
TOWN OF MT. CRESTED BUTTE, COLORADO, THAT:**

*Section 1. Annexation.* The real property described in Exhibit A, attached hereto and incorporated herein, is hereby annexed to and made a part of the Town of Mt. Crested Butte, Colorado.

*Section 2. Annexation Map.* The real property described in Exhibit A, and herein annexed, is depicted in the Annexation Map, attached hereto as Exhibit B.

*Section 3. Annexation and Development Agreement.* The annexation of the real property described in Exhibit A is subject to those provisions contained in the "Annexation and Development Agreement" executed by the Town of Mt. Crested Butte, Colorado, and CBMR Real Estate, LLC, as owner of said property.

*Section 4. Recording.* The Clerk of the Town of Mt. Crested Butte is hereby authorized and directed to record with the County Clerk of the County of Gunnison,



2 of 5 R 25.00 D 0.00 N 0.00 Gunnison County

Ordinance No. 1  
Series 2001  
Page Two

Colorado, copies of this ordinance, the Annexation Map, and the Annexation and Development Agreement, as required by law.

INTRODUCED, READ, APPROVED, AND ORDERED PUBLISHED on first reading at a regular meeting of the Town Council of the Town of Mt. Crested Butte, Colorado, held this 20<sup>th</sup> day of March, 2001.

INTRODUCED, READ, AND APPROVED ON SECOND READING at a regular meeting of the Town Council of the Town of Mt. Crested Butte, Colorado, held the 13<sup>th</sup> day of April, 2001.



TOWN OF MT. CRESTED BUTTE, COLORADO

By *Gwen Pettit*  
Gwen Pettit, Mayor

ATTEST:  
*Laura W. Welch*  
Laura W. Welch, Town Clerk



510801 05/21/2001 02:54P 289  
3 of 5 R 25.00 D 0.00 N 0.00 Gunnison County

## EXHIBIT A

### Legal Description of Annexation Property – East Trade Parcel

Lot 14, Section 13, Township 13 South, Range 86 West, of the Sixth Principal Meridian;

Lot 7, Lot 8 and Lot 11, Section 19, Township 13 South, Range 85 West, of the Sixth Principal Meridian;

The following areas of Section 24, Township 13 South, Range 86 West, of the Sixth Principal Meridian:

NE $\frac{1}{4}$  NW $\frac{1}{4}$ ,  
W $\frac{1}{2}$  NW $\frac{1}{4}$  NE $\frac{1}{4}$ ,  
NW $\frac{1}{4}$  SE $\frac{1}{4}$  NW $\frac{1}{4}$  NE $\frac{1}{4}$ ,  
S $\frac{1}{2}$  SE $\frac{1}{4}$  NW $\frac{1}{4}$  NE $\frac{1}{4}$ ,  
S $\frac{1}{2}$  SW $\frac{1}{4}$  NE $\frac{1}{4}$  NE $\frac{1}{4}$ ,  
N $\frac{1}{2}$  N $\frac{1}{2}$  SE $\frac{1}{4}$  NW $\frac{1}{4}$ ,  
SW $\frac{1}{4}$  NE $\frac{1}{4}$ ,  
W $\frac{1}{2}$  SE $\frac{1}{4}$  NE $\frac{1}{4}$ ,  
W $\frac{1}{2}$  NE $\frac{1}{4}$  SE $\frac{1}{4}$  NE $\frac{1}{4}$ ,  
SE $\frac{1}{4}$  SE $\frac{1}{4}$  NE $\frac{1}{4}$ ,  
SE $\frac{1}{4}$

Containing an aggregate of 412.96 acres, more or less.

County of Gunnison  
State of Colorado

# EAST TRADE PARCEL ANNEXATION

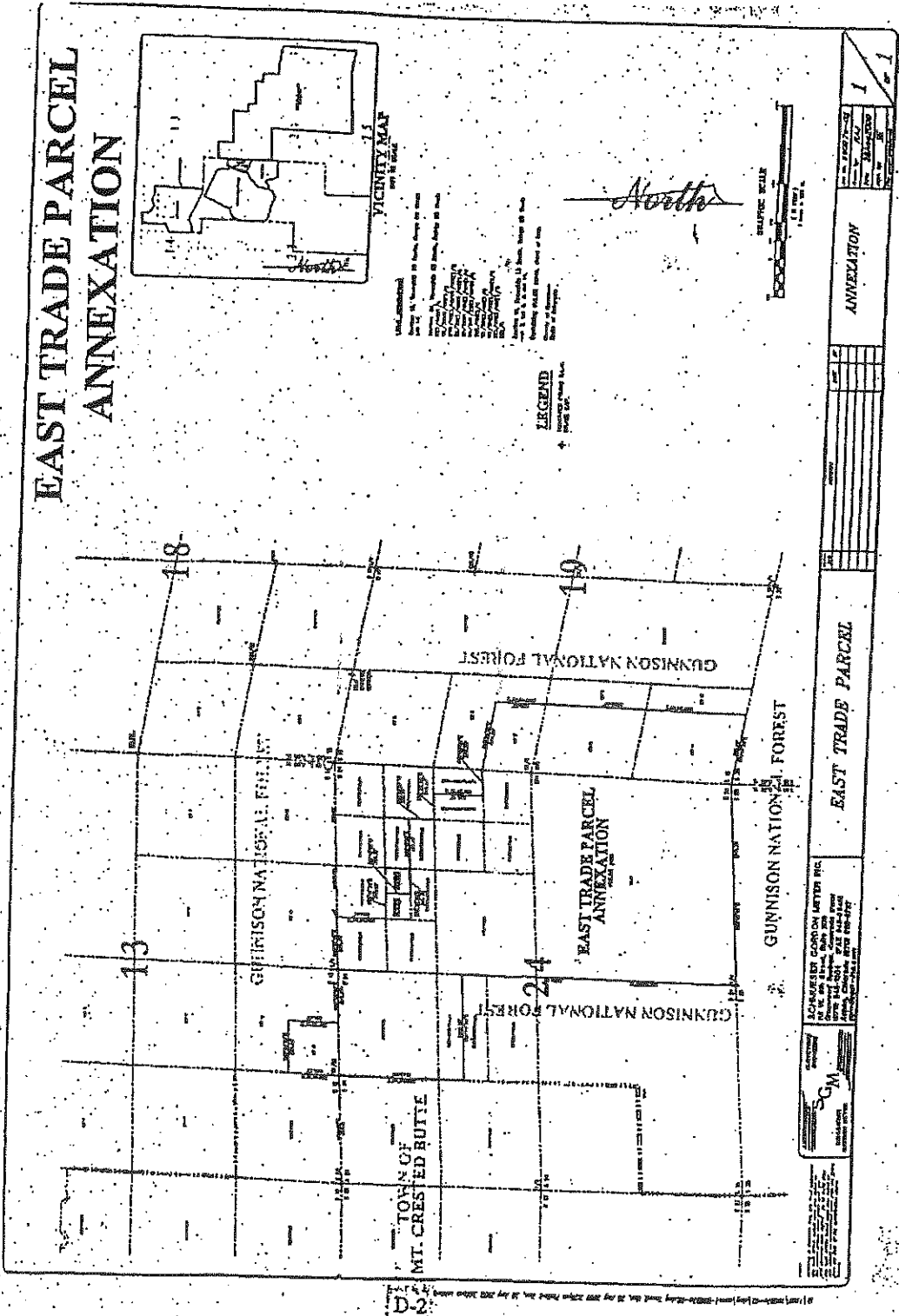

510801 05/21/2001 02:54P 289  
4 of 5 R 25.00 D 0.00 N 0.00 Gunnison County

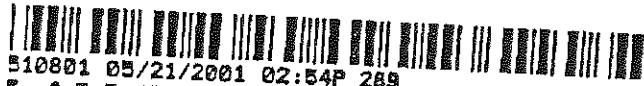

510801 05/21/2001 02:54P 269  
5 of 5 R 25.00 D 0.00 N 0.00 Gunnison County

CERTIFICATE

I hereby certify that the foregoing four pages constitute a true and correct copy of Ordinance No. 1, Series 2001, passed on second reading by the Town Council of the Town of Mt. Crested Butte, Colorado, on April 13, 2001.

*Laura W. Welch*  
\_\_\_\_\_  
Laura W. Welch  
Town Clerk

