

**Peanut Lake Road**

The dirt road West of Butte Avenue is a county road and no leashes are required

**B79 / Dirt Jump Area**

5 acres near the public biking/walking path, adjacent to the BMX bike course

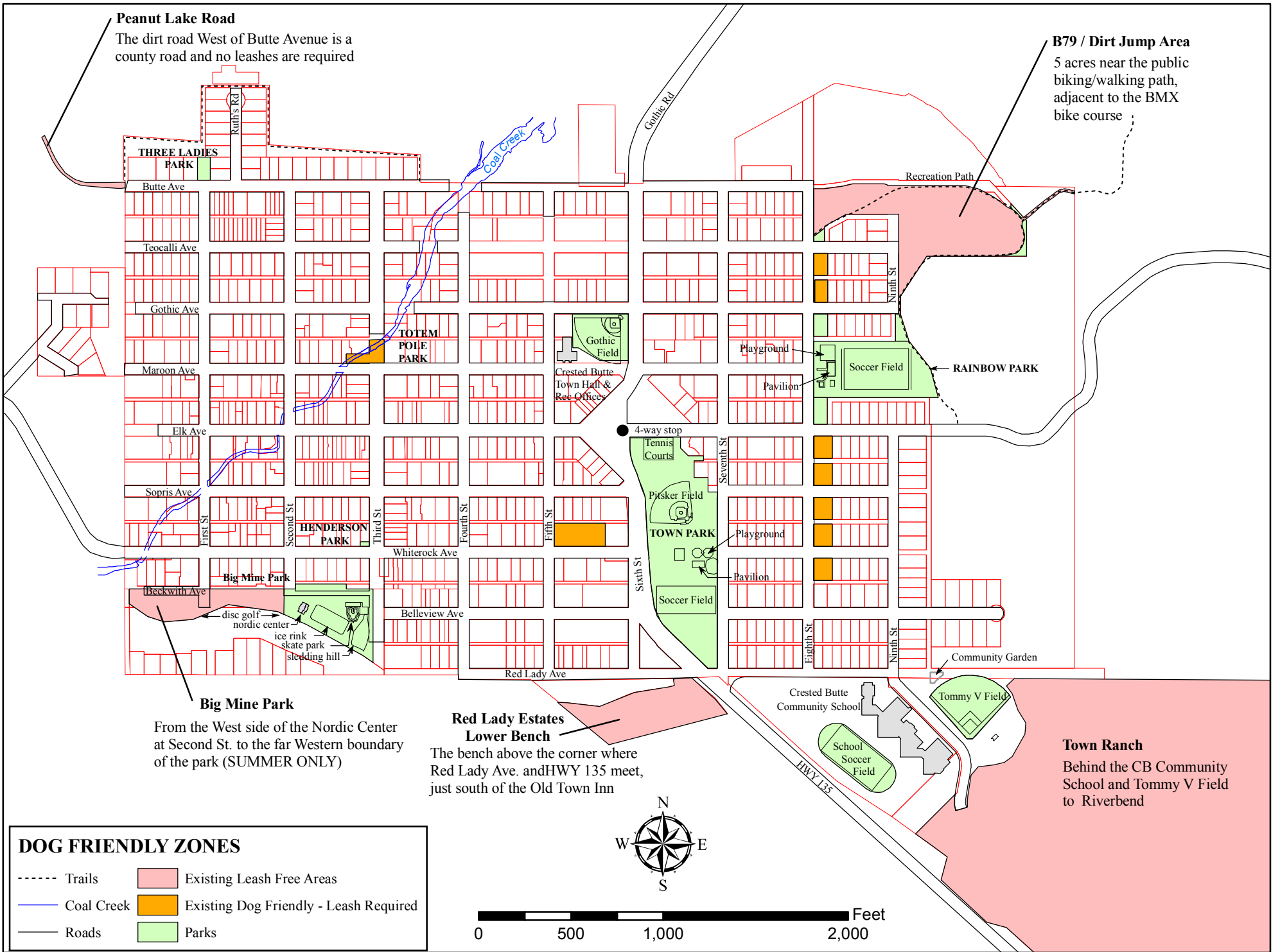

**Big Mine Park**  
From the West side of the Nordic Center at Second St. to the far Western boundary of the park (SUMMER ONLY)

**Red Lady Estates Lower Bench**  
The bench above the corner where Red Lady Ave. and HWY 135 meet, just south of the Old Town Inn

**DOG FRIENDLY ZONES**

- Trails
- Existing Leash Free Areas
- Coal Creek
- Existing Dog Friendly - Leash Required
- Roads
- Parks

